

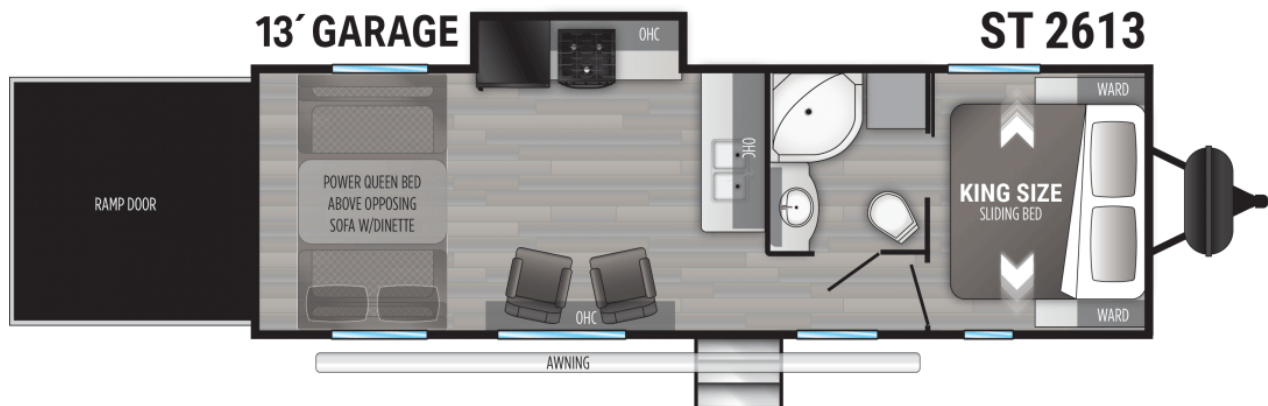

Scan to see more about this model on-line!

# STRYKER



## Top 10 Selling Features

*Cruise On!*

- 5/8" Tongue and groove plywood floors
- Patent Pending king bed slide system
- Double-down dual ducted A/C and high BTU ducted furnace
- Maximum storage
- Solar and WiFi Prep
- Max Foundation - 102" Wide body construction, heavy duty construction
- Azdel composite laminated sidewalls with 5-sided aluminum framing
- Heavy duty axles with easy lube hubs and self-adjusting brakes
- Standard generator prep with 30 gallon fuel tank, and fuel pump in an insulated compartment
- Extended season package with radiant foil and 2" heat duct in enclosed underbelly

## ST2613 by Cruiser

GVWR	12,800 Lbs
Dry Weight	7,780 Lbs
Hitch Weight	1,080 Lbs
Dimensions*	8'-6"W x 12'-10"H x 30'-9"L
Sleeping Capacity	5-6 People
Axles	2 x 6000lb Axles
Fresh Tank	98 Gal
Gray Tank	57 Gal
Black Tank	57 Gal
Water Heater	10 Gal
Furnace	35,000 BTU
Air Conditioner	15,000 BTU
Number of Slides	1
Slide Room Height	6'-2-1/2" Slide Room Height
Bedroom Height	7'-6" Bedroom Ceiling
Awning Length	19'
Cook Top	3 Burner
Traditional Oven	YES
Convection Oven	No
Microwave Oven	
Generator Prep	Optional
Bed Dimensions	King

\*Overall length defined as tow point (ball coupler for travel trailers / king pin for fifth wheel trailers) to rear bumper. It does not include rear ladder or spare tire. Optional pin boxes will affect overall length. \*\*Garage length is defined as ramp door to full interior wall. Standard or optional equipment may reduce overall garage dimensions. Information provided is accurate as of 3/3/2021 and is subject to update & change. Please confirm with your local Cruiser Dealership for up to date information.



[www.cruiservv.com](http://www.cruiservv.com)

Cruiser RV, LLC  
7805 North SR 9 • Howe, IN 46746  
260-562-3500